

HLR 7955A Hydraulic Interface Valve

Two position, three way **Normally Closed**, pilot supply pressure operated, spring return, 10,000 PSI, flow control valve that has a manual operate (By-Pass) Handle. A Pilot Supply pressure of 80 PSI is required for controlling hydraulic pressure of 10,000 PSI.



Design Features:

Dimensions: 2.500" Dia. x 5.250" L.

Working Pressure: Pilot Supply - 80-150 PSI

Hydraulic Supply - 10,000 PSI Max.

Connections: 1/4" - 18 NPT.

Weight: 4.5 lbs.

Bolt Holes: 2 Places - 1/4"-20 UNC on a 1 3/4" bolt hole circle.

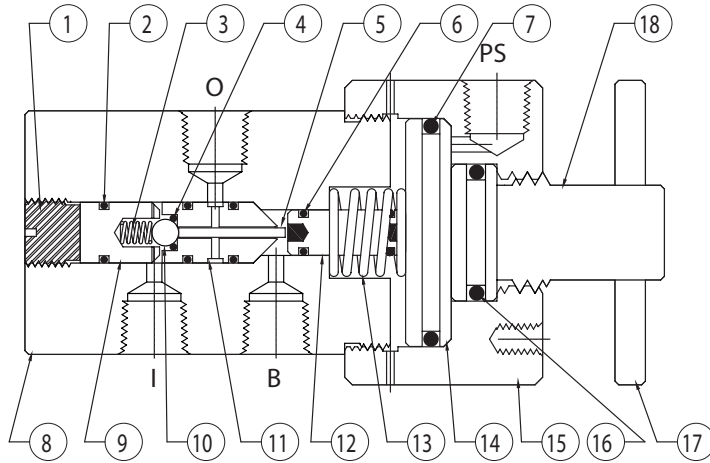

BILL OF MATERIAL

ITEM	PART NAME	PART NUMBER	MATERIAL
1.	Screw	7954	316SS
2.	O-Ring (3)	AS-012V95	Viton
3.	Spring	.210x.375x22	316SS
4.	O-Ring	AS-008VTC	Viton Teflon Coated
5.	Pin	.078x.875	316SS
6.	O-Ring (2)	AS-010V75	Viton
7.	O-Ring	AS-223V75	Viton
8.	Body	7953	316SS
9.	Seal	7898A	316SS
10.	Ball	7/32TC	Tungsten Carbide
11.	Lower Seat	7897B	316SS
12.	Upper Seat	7895C	316SS/Kevlar Nylon
13.	Spring	.72x1x35	302SS
14.	Piston	7952	316SS
15.	Cap	7957	316SS
16.	O-Ring	AS-212V75	Viton
17.	Handle	.25"x 2.5" Tube	316SS
18.	By Pass Screw	7956AP	316SS

NOTE: Item #12 is reversible.

Other Models of the 7955A Series

HLR 7955AH - Hydraulic Pilot Supply

HLR 7955ABN - Buna Seals

HLR 7955AT - Teflon ball check seal (for use with high flow hydraulic pumps)

HLR 7955AHT - Hydraulic Pilot Supply with Teflon ball check seal

HLR 7955AP - Special Position Indicating Knob